

SYSTEM 4500

TECHNICAL INFORMATION
SYSTEM DESCRIPTION

SYSTEM 4500

SYSTEM DESCRIPTION

Description, Technical Data

| | |
|-------------------------|---|
| Window Types | Fixed windows, tilt-turn windows (dual action), hopper and awning windows, hinged and tilt-slide doors |
| Material | Cadmium- and lead-free RAU-PVC |
| Sealing System | Twin-compression seals |
| System Depth | 82.5 mm (3 1/4") frame depth for residential applications, 60 mm (2 3/8") frame depth commercial applications |
| Frame/Sash Overlap | 8 mm (5/16") |
| Seal Gap | Nominal 3 mm (1/8") |
| Hardware Allowance | 13 mm (1/2") |
| Max. Glass Thickness | 32 mm (1 1/4") |
| Sightlines Frame / Sash | 120 mm - 166 mm (4.724" - 6.535") |
| Colors | White and beige; woodgrain and solid colored film can be laminated on the inside and outside surfaces |
| U-Values | Down to 0.21 (Btu/hr-ft 2°F); Ask REHAU sales offices for actual test reports |
| Structural Tests | Up to design pressures of 100 psf; Ask REHAU sales offices for actual test reports |
| Sound Reduction | Up to 43 db; Ask REHAU sales offices for actual test reports |

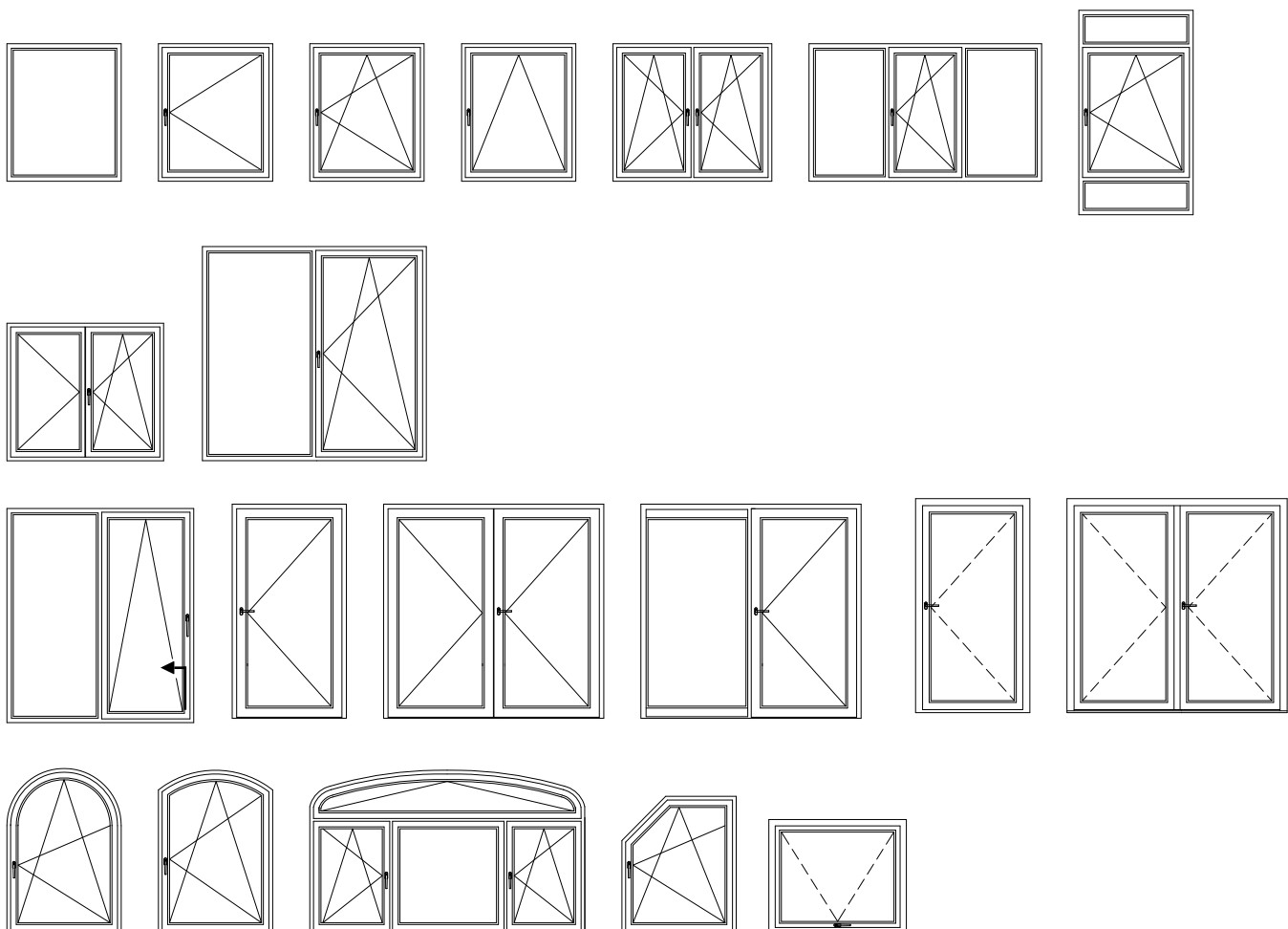

SYSTEM 4500

SYSTEM DESCRIPTION

Features and Benefits for Windows

- 1 Common compression seal on frame and sash**
Streamlines inventory and production
- 2 Common 35 mm (1 3/8") reinforcement for sash, frame and T-mullion**
Reduces storage; provides exceptional thermal insulation even when reinforcements with high static values are used
- 3 Nubs in the reinforcement chambers of frame and sash**
Stabilize the reinforcement during the production process
- 4 Hardware fastened through three walls of PVC or into the reinforcement**
Assures effective transfer of sash loads to the frame
- 5 Identical rebate shape for frame, sash and T-mullion**
Requires only one cutter stack for all mechanical joints
- 6 Continuous twin-compression seal in frame and sash upstand**
Provides protection against drafts, dust, water and heat-loss
- 7 Sloped frame and mullion rebates**
Allow for easy cleaning and support water drainage to the outside

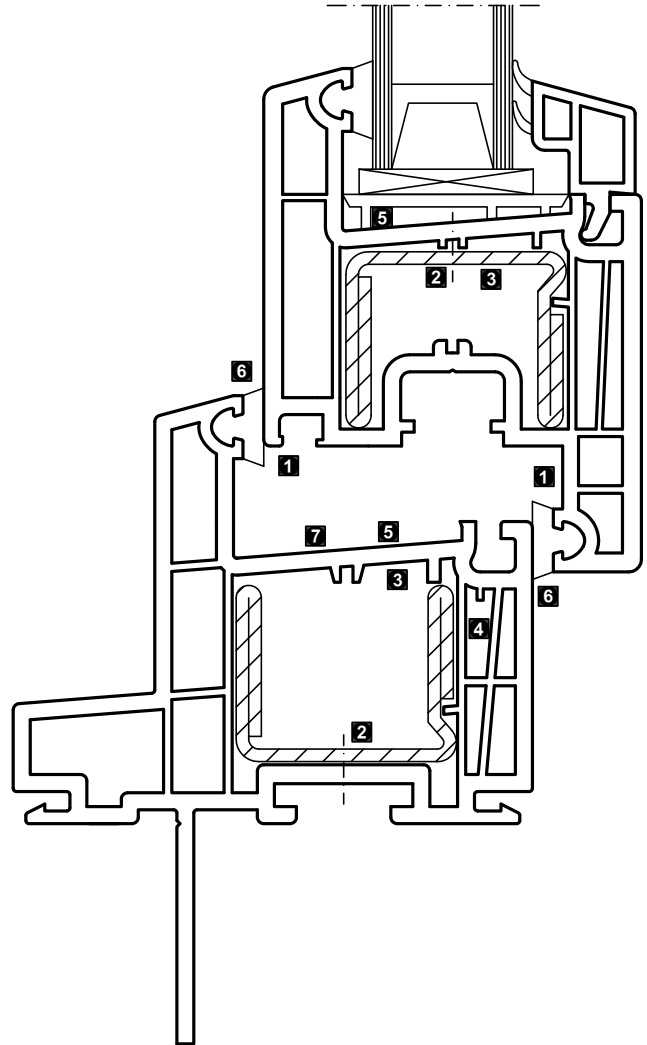

SYSTEM 4500

SYSTEM DESCRIPTION

Features and Benefits for Doors

- 1 Common compression seal on frame and sash**
Streamlines inventory and production
- 2 Steel reinforcement in door sash**
Provides excellent stiffness; weldable corner joints for door sash connect the reinforcement in all four corners providing torsion stability
- 3 Hardware fastened through three walls of PVC or into the reinforcement**
Assures effective transfer of sash loads to the frame
- 4 Identical rebate shape for frame, sash and T-mullion**
Requires only one cutter stack for all mechanical joints
- 5 Continuous seal around perimeter of frame and threshold**
Provides protection against drafts, dust, water and heat-loss
- 6 Sloped rebate**
Allows for easy cleaning and supports water drainage to the outside

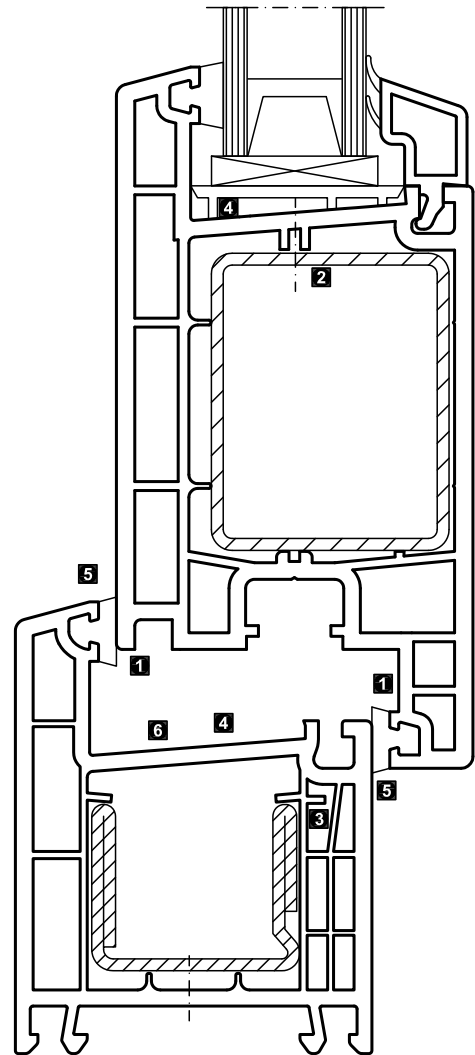
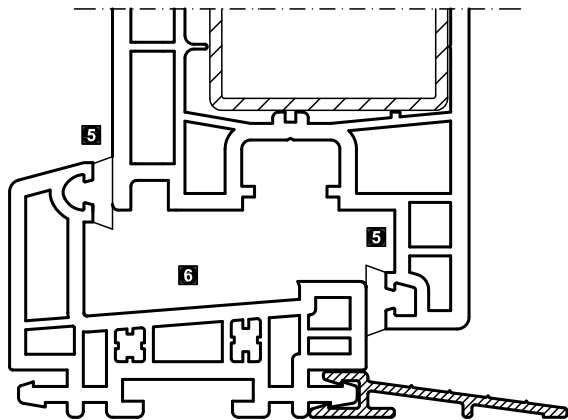

For updates to this publication, visit na.rehau.com/resourcecenter

The information contained herein is believed to be reliable, but no representations, guarantees or warranties of any kind are made as to its accuracy, suitability for particular applications or the results to be obtained therefrom. Before using, the user will determine suitability of the information for user's intended use and shall assume all risk and liability in connection therewith. To the extent permitted by law, REHAU EXPRESSLY DISCLAIMS ALL IMPLIED WARRANTIES, INCLUDING BUT NOT LIMITED TO, ANY IMPLIED WARRANTIES OF MERCHANTABILITY OR OF FITNESS FOR A PARTICULAR PURPOSE.

© REHAU Incorporated 2008 Printed in USA